

JBMFT/MFLWT80/609 Metal Bellow Mechanical Seal 609 (JBMFT/MFLWT80)型 金属波纹管机械密封

Structural Features: single end, balanced, independent direction of rotation, metal bellow, cartridge seal. The auxiliary seal ring is made of expanded graphite, which is suitable for complex operating conditions and mixed sealed mediums. This seal component is easy to install and adjust and has specifically great performance while used in medium-and-high viscosity and high or low temperature content.

结构特点: 单端面、平衡型、任意旋向、波纹管传动。波纹管既能提供端面闭合力，又能传递扭矩作用；柔性石墨能适用于比较复杂或混合介质的工况，追随性好，抗干扰能力强；安装简单、调整方便；尤其适合中高粘度、高温和低温介质中使用。

Standards: DIN24960, ISO3069, GB6556, EN12756
符合标准: DIN24960, ISO3069, GB6556, EN12756

Inner Diameter: 25 mm to 100 mm
规格范围: 25 - 100 mm

Materials

Rotary Ring Face: Carbon/SiC/TC

Stationary Ring Face: SiC/TC

Elastomers: Expanded Graphite

Springs: AM350/Inconel 718/HC-276
Metal Parts: 410S/SS316L/4J42/Hastelloy

材料

旋转环端面: 石墨/碳化硅/碳化钨

静止环端面: 碳化硅/碳化钨

辅助密封: 柔性石墨

弹簧: AM350/Inconel 718/HC-276

金属部件: 410S/SS316L/4J42/哈氏合金

Scopes of Application: mainly used in chemical pumps, oil pumps, screw pumps and oil extraction equipment for industries such as chemical engineering, oil refining, chemical fiber, food processing, pharmacy, thermoelectricity, and paper making.

应用领域: 广泛应用于化工、炼油、化纤、食品、医药、热电、造纸等领域。可同化工泵、油泵、螺杆泵、采油设备等旋转设备配套。

Operation Parameters

Pressure: - 0.1 ~ 2.5 MPa

Temperature: - 75 ~ 400 °C

Linear Speed: ≤ 15 m/s

运行参数

压力: - 0.1 ~ 2.5 MPa

温度: - 75 ~ 400 °C

线速度: ≤ 15 m/s

Mediums: oil, liquid hydrocarbon, acid, alkali, solvent, paper pulp and other high or low temperature and medium-and-high viscosity content.

适用介质: 油类、液态烃、酸、碱、溶剂、纸浆等高低温中高粘度介质。

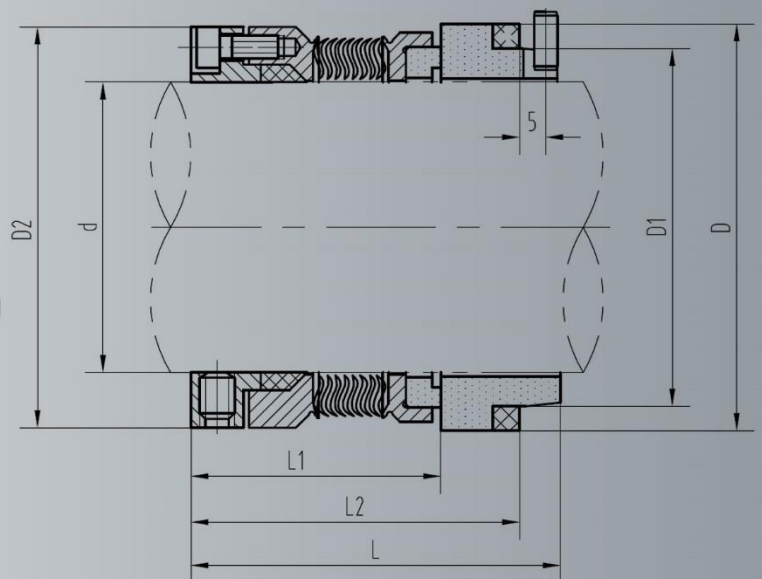

609 (JBMFT/MFLWT80) Mechanical Seal Dimension Chart
- 609 (JBMFT/MFLWT80)型机械密封尺寸对照表

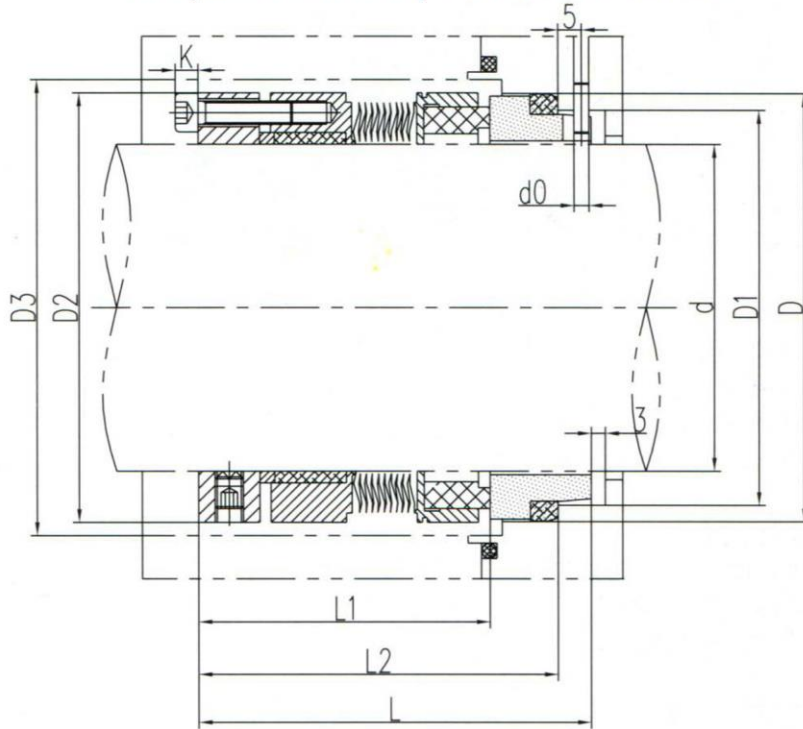

Dimensions Shaft Sizes	d	D	D1	D2	D3	L	L1	L2	d0	k
	h6	H8	H11							
25	25	45.0	39.0	47	51	66.0	46.5	58.0	3	5
28	28	48.0	42.0	50	54	66.0	46.5	58.0	3	5
30	30	50.0	44.0	52	56	66.0	46.5	58.0	3	5
33	33	56.0	49.0	55	59	68.5	46.5	60.5	3	5
35	35	58.0	51.0	57	61	68.5	46.5	60.5	3	5
38	38	61.0	54.0	60	64	68.5	46.5	60.5	4	5
40	40	63.0	56.0	66	70	69.5	47.5	61.5	4	6
43	43	66.0	59.0	69	73	69.5	47.5	61.5	4	6
45	45	70.0	62.0	71	75	70.5	47.5	62.5	4	6
50	50	75.0	67.0	76	80	70.5	47.5	62.5	4	6
55	55	80.0	72.0	81	86	70.5	47.5	62.5	4	6
60	60	85.0	77.0	87	92	76.0	53.0	68.0	4	6
65	65	92.0	83.0	92	97	79.0	53.0	71.0	4	6
70	70	97.0	88.0	97	102	79.0	53.0	71.0	4	6
75	75	105.0	95.0	102	107	79.0	52.8	71.0	4	6
80	80	110.0	100.0	107	112	79.0	52.8	71.0	4	6
85	85	115.0	105.0	112	117	79.0	52.8	71.0	4	6
90	90	120.0	110.0	117	122	79.0	53.8	71.0	4	6
95	95	125.0	115.0	122	127	79.0	53.8	71.0	4	6
100	100	134.3	122.2	127	132	84.0	54.0	74.0	4	6